

ユニオン90°エルボ

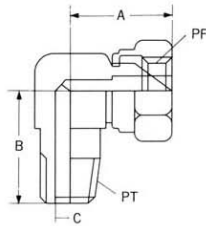

PT	PF	A	B	C	Hex
1/4	1/4	27	25	5.5	19
3/8	3/8	34	30	7.0	22
1/2	1/2	36	36	10.0	27
3/4	3/4	40	43	16.0	36
1"	1"	45	50	21.5	41

ユニオン45°エルボ

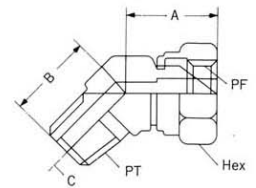

PT	PF	A	B	C	Hex
1/4	1/4	22	17	5.5	19
3/8	3/8	27	22	7.0	22
1/2	1/2	30	27	10.0	27
3/4	3/4	34	30	16.0	36
1"	1"	38	34	21.5	41

TB-13

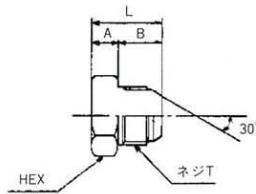

ネジT	L	A	B	HEX	概略重量g
1/8 G	20.0	7	13.0	14	15
1/4 G	24.0	8	16.0	17	35
3/8 G	25.0	8	17.0	19	45
1/2 G	30.0	10	20.0	22	75
3/4 G	33.5	12	21.5	32	160
1 G	36.5	14	22.5	36	250
1 1/4 G	41.0	14	27.0	46	460
1 1/2 G	41.0	14	27.0	50	575
2 G	47.0	17	30.0	60	1,005

TB-04

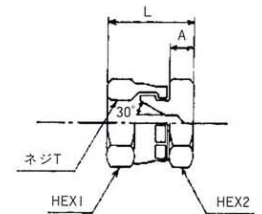

ネジT	HEX1	HEX2	L	A	概略重量g
1/8 G	14	14	19	6	20
1/4 G	19	17	23	8	40
3/8 G	22	19	26	8	55
1/2 G	27	22	29	10	80
3/4 G	36	32	34	12	180
1 G	41	36	37	14	260
1 1/4 G	50	46	42	14	375
1 1/2 G	60	50	42	14	530
2 G	70	60	49	17	820

TB-09

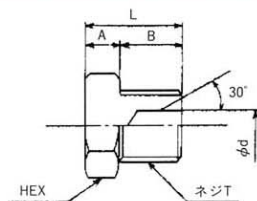

ネジT	L	A	B	φd	HEX	概略重量g
1/4 G	21	8	13	5.5	17	30
3/8 G	23	8	15	7.0	19	40
1/2 G	28	10	18	10.0	22	70
3/4 G	32	12	20	16.0	32	130
1 G	36	14	22	21.5	36	185
1 1/4 G	38	14	24	27.5	46	340
1 1/2 G	38	14	24	33.0	50	400
2 G	45	17	28	44.0	60	670

TB-05

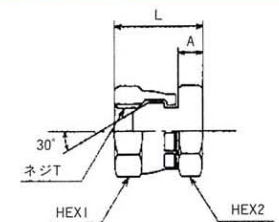

ネジT	HEX1	HEX2	L	A	概略重量g
1/4 G	19	17	25	8	50
3/8 G	22	19	27	8	60
1/2 G	27	22	32	10	100
3/4 G	36	32	35	12	220
1 G	41	36	40	14	300
1 1/4 G	50	46	43	14	510
1 1/2 G	60	50	43	14	710
2 G	70	60	52	17	1,110

TL-13

ロングアダプター

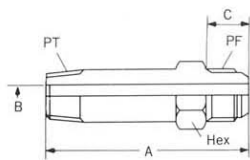

PT	PF	A	B	C	Hex
1/4	1/4	80	5.5	16.0	19
3/8	3/8	85	7.0	17.5	22
1/2	1/2	100	10.0	20.0	27
3/4	3/4	113	16.0	21.5	36
1"	1"	125	21.5	22.5	41

TL-09

ロングアダプター

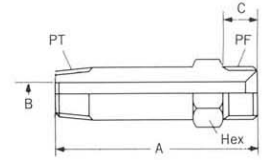

PT	PF	A	B	C	Hex
1/4	1/4	75	5.5	13	19
3/8	3/8	83	7.0	15	22
1/2	1/2	98	10.0	18	27
3/4	3/4	115	16.0	20	36
1"	1"	128	21.5	22	41

TL-33

ロングエルボ

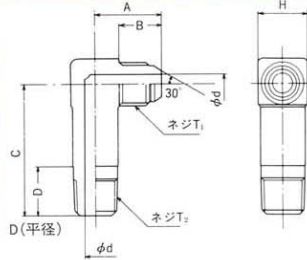

ネジT ₁	ネジT ₂	A	B	C	D	φd	H	概略重量g
1/4G	R1/4	24.0	16.0	57	17	5.5	16	95
3/8G	R3/8	27.5	17.5	62	20	7.0	19	145
1/2G	R1/2	32.0	20.0	64	24	10.0	24	230
3/4G	R3/4	36.0	21.5	85	28	16.0	30	380

TL-34

ロングエルボ

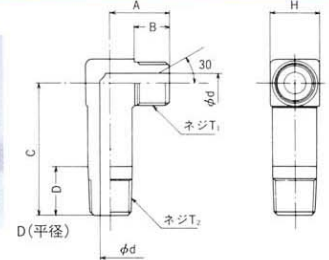

ネジT ₁	ネジT ₂	A	B	C	D	φd	H	概略重量g
1/4G	R1/4	21	13	57	17	5.5	16	90
3/8G	R3/8	24	14	62	20	7.0	19	140
1/2G	R1/2	29	17	64	24	10.0	24	240
3/4G	R3/4	33	18	85	28	16.0	30	385

T-34-FPT

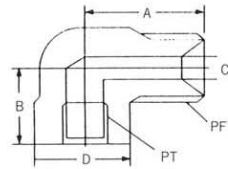

PT	PF	A	B	C	D
1/4	1/4	27	15	5.5	23
3/8	3/8	30	23	7.0	27
1/2	1/2	36	26	10.0	32

T-33-FPT

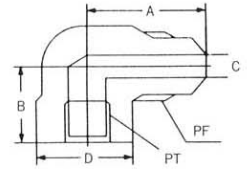

PT	PF	A	B	C	D
1/4	1/4	30	15	5.5	23
3/8	3/8	33	23	7.0	27
1/2	1/2	40	26	10.0	32

T-10

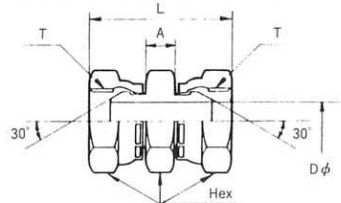

呼び径	ねじT	A	D	L	Hex
6	PF1/4	8	5.5	42	19
9	PF3/8	8	7.0	46	22
12	PF1/2	10	10.0	54	27
19	PF3/4	12	16.0	60	36
25	PF1	12	21.5	64	41
32	PF1 1/4	14	27.5	73	50
38	PF1 1/2	14	33.5	73	60
50	PF2	17	44.0	87	70